

# CS62U

## 2-Port USB KVM Switch

CS62U 2-Port USB KVM Switch has a handy design integrating with 1.8m of cables. It can control 2 servers via a single console.

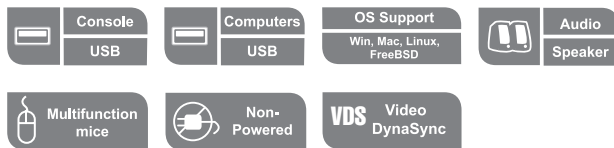

### Diagram

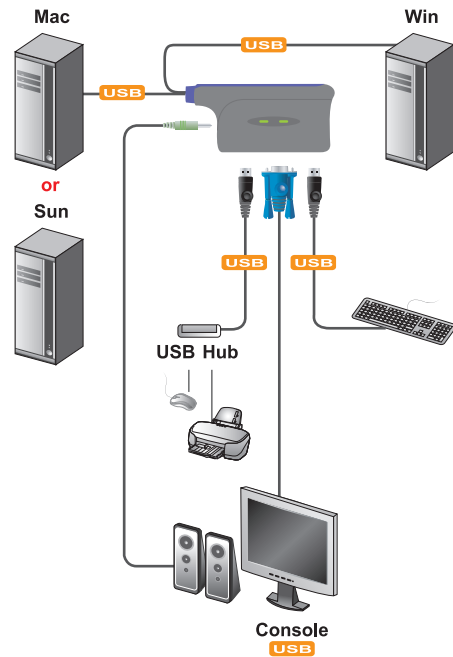

Supports computers that are equipped with speakers

### Features

- One USB console controls two USB computers
- Compact design, built-in 1.8 m cables
- Hotkey selection for OS and keyboard language
- Multiplatform support – compatible with all operation platforms PC (Windows, Linux and most others), Mac and Sun.
- Video DynaSync™ – stores the console monitors' EDID (Extended Display Identification Data) to optimize display resolution
- USB mouse port can be used for USB hub and USB peripheral sharing
- Supports multimedia USB keyboards and multifunction mice
- All-in-one design
- With speaker support
- Superior video quality – up to 2048 x 1536; DDC2B
- Auto Scan function to monitor computer operation
- Non-powered
- ATEN USB ASIC inside

### Specifications

Function		CS62U	
Computer Connections		2	
Computer Port Selection		Hotkey	
Connectors	Console Ports	Keyboard	1 x USB Type A Female (White)
		Video	1 x HDB-15 Female(Blue)
		Mouse	1 x USB Type A Female (White)
	KVM Ports	Speaker	1 x Mini Stereo Jack Female (Green)
		Keyboard/ Mouse	2 x USB Type A Male(Black)
		Video	2 x HDB-15 Male(Blue)
	Speaker	2 x Mini Stereo Plug Male (Green)	
LED	Selected	2 (Green)	
Cable Length	Computers	1.8m	
Emulation	Keyboard/Mouse	USB	
Video		2048 x 1536, DDC2B	
Scan Interval		5 seconds	
Environment	Operating Temp.	0°~50°C	
	Storage Temp.	-20°~60°C	
	Humidity	0~80% RH, Non-condensing	
Physical Properties	Housing	Plastic	
	Weight	0.40kg	
	Dimensions ( L x W x H )	8.10 x 6.90 x 2.60 cm	

\* The specifications and pictures are subject to change without notice.